

# MODEL 975XL

## Reduced Pressure Principle Backflow Preventers 3/4" to 2"

# WILKINS

A **ZURN**™ Company

ITEM NO.	DESCRIPTION	3/4"	1"	1-1/4"	1-1/2"	2"
1	BALL VALVE, TAPPED	34-850T	1-850T	114-850T	112-850T	2-850T
2	BALL VALVE	34-850	1-850	114-850	112-850	2-850
3	O-RING, CHECK SEAT	125N	125N	142N	142N	142N
4	CHECK SEAT	952-18S	952-18S	954-18S	954-18S	954-18S
5	RETAINING BOLT	952-11	952-11	952-11	952-11	952-11
6	SEAL RING RETAINER	952-14	952-14	954-14	954-14	954-14
7	SEAL RING	952-12S	952-12S	954-12S	954-12S	954-12S
8	POPPET	952-30	952-30	954-30	954-30	954-30
9	NO. 1 CHECK SPRING	972-33	972-33	5754-33	5754-33	5754-33
10	O-RING, COVER	136N	136N	153N	153N	153N
11	CHECK COVER	952-3-010F	952-3-010F	954-3-010F	954-3-010F	954-3-010F
12	POPPEY ASSY.	952-300S	952-300S	954-300S	954-300S	954-300S
13	NO. 2 CHECK SPRING	952-33	952-33	554-33	554-33	554-33
14	TEST COCK	18-860	18-860	14-860	14-860	14-860
15	O-RING, RELIEF VALVE SEAT	019N	019N	029N	029N	029N
16	RELIEF VALVE SEAT	972-18	972-18	974-18	974-18	974-18
17	RELIEF VALVE SPRING	972A-33	972A-33	974A-33	974A-33	974A-33
18	RELIEF VALVE RETAINING BOLT	972-11A	972-11A	604B-11	604B-11	604B-11
19	RELIEF VALVE SEAL RING RETAINER	972-14	972-14	552-14	552-14	552-14
20	RELIEF VALVE SEAL RING	972-12S	972-12S	974-12S	974-12S	974-12S
21	RELIEF VALVE LOWER PLUNGER	972-34A	972-34A	974-34A	974-34A	974-34A
22	RELIEF VALVE DIAPHRAGM	972-43	972-43	974-43	974-43	974-43
23	RELIEF VALVE UPPER PLUNGER	972-34	972-34	974-34	974-34	974-34
24	O-RING, RELIEF VALVE STEM	111N	111N	121N	121N	121N
25	RELIEF VALVE STEM ASSY.	972-50S	972-50S	974-50S	974-50S	974-50S
26	RELIEF VALVE COVER BOLT	554-11A	554-11A	554-11A	554-11A	554-11A
27	R.V. & CHECK SEAT TOOL KIT	RK-975 TOOL				

### REPAIR KITS

NO. RK34-975XL			REPAIR KIT COMPLETE Model 975XL 3/4" & 1" Only			NO. RK114-975XL			REPAIR KIT COMPLETE Model 975XL 1-1/4", 1-1/2", 2" Only		
PART NO.	QTY.	DESCRIPTION	PART NO.	QTY.	DESCRIPTION	PART NO.	QTY.	DESCRIPTION	PART NO.	QTY.	DESCRIPTION
952-12S	2	SEAL RING	954-12S	2	SEAL RING						
972-12S	1	RELIEF VALVE SEAL RING	974-12S	1	RELIEF VALVE SEAL RING						
972-43	1	DIAPHRAGM	974-43	1	DIAPHRAGM						
136N	2	O-RING, COVER	153N	2	O-RING, COVER						
111N	1	O-RING, RELIEF VALVE STEM	121N	1	O-RING, RELIEF VALVE STEM						
972-33	1	NO. 1. CHECK SPRING	5754-33	1	NO. 1. CHECK SPRING						
952-33	1	NO. 2 CHECK SPRING	554-33	1	NO. 2 CHECK SPRING						
972A-33	1	RELIEF VALVE SPRING	974A-33	1	RELIEF VALVE SPRING						
NO. RK34-975XLR			RUBBER REPAIR KIT Model 975XL 3/4" & 1" Only			NO. RK114-975XLR			RUBBER REPAIR KIT Model 975XL 1-1/4", 1-1/2", 2" Only		
PART NO.	QTY.	DESCRIPTION	PART NO.	QTY.	DESCRIPTION	PART NO.	QTY.	DESCRIPTION	PART NO.	QTY.	DESCRIPTION
952-12S	2	SEAL RING	954-12S	2	SEAL RING						
972-12S	1	RELIEF VALVE SEAL RING	974-12S	1	RELIEF VALVE SEAL RING						
972-43	1	DIAPHRAGM	974-43	1	DIAPHRAGM						
136N	2	O-RING, COVER	153N	2	O-RING, COVER						
111N	1	O-RING, RELIEF VALVE STEM	121N	1	O-RING, RELIEF VALVE STEM						

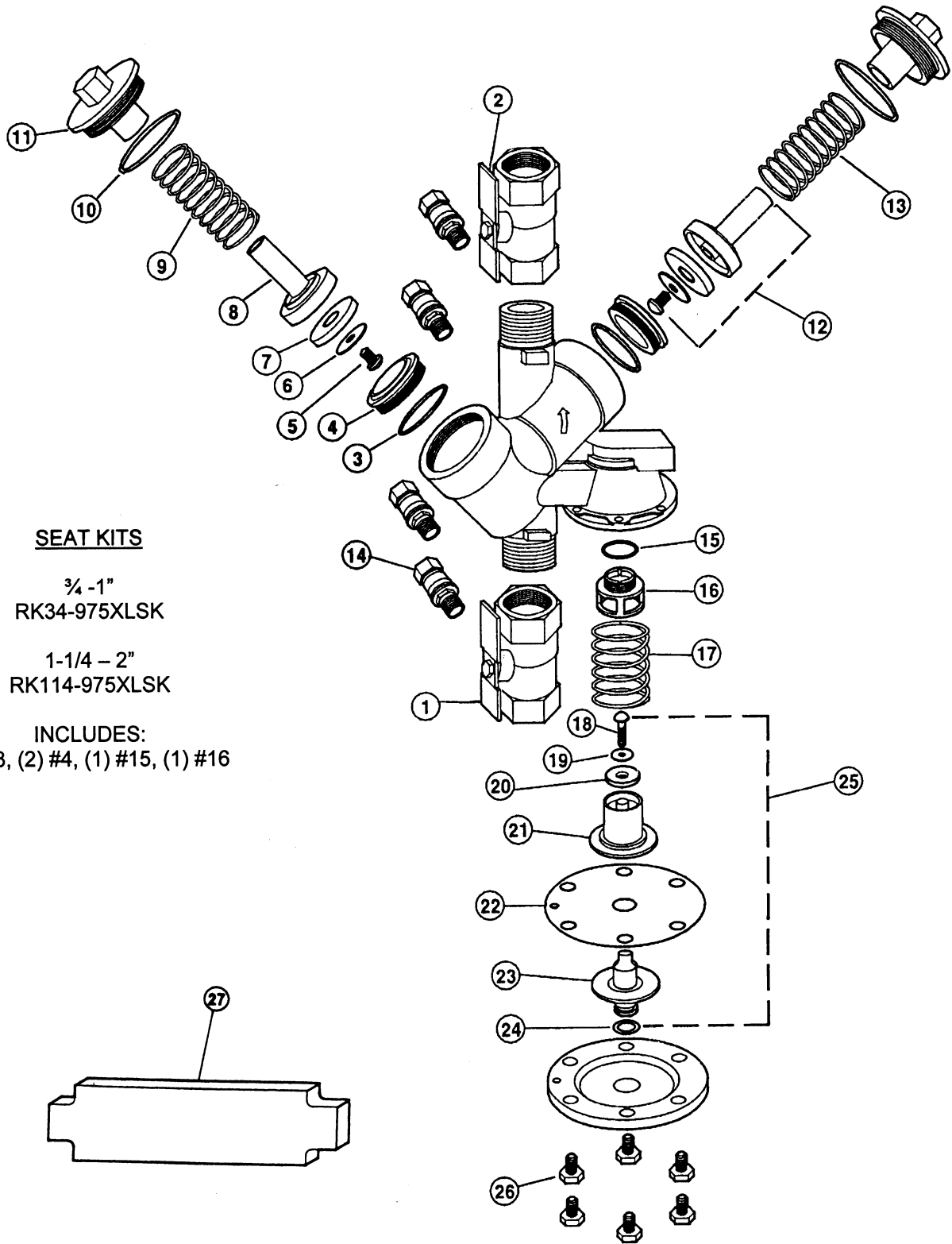

**SEAT KITS**

3/4 - 1"  
 RK34-975XLSK

1-1/4 - 2"  
 RK114-975XLSK

INCLUDES:  
 (2) #3, (2) #4, (1) #15, (1) #16